

The Interstate Class mixer was carefully and methodically developed over five years of field testing to strike a balance between durability and weight savings.

beck
concrete mixers

INTERSTATE CLASS

Beck Industrial Interstate Class mixers last longer and deliver more concrete than industry competitors, without carrying unnecessary weight. See how the revolutionary bolt-on, spherical bearing mounted trailer axles improve ride quality and stability, and reduce downtime.

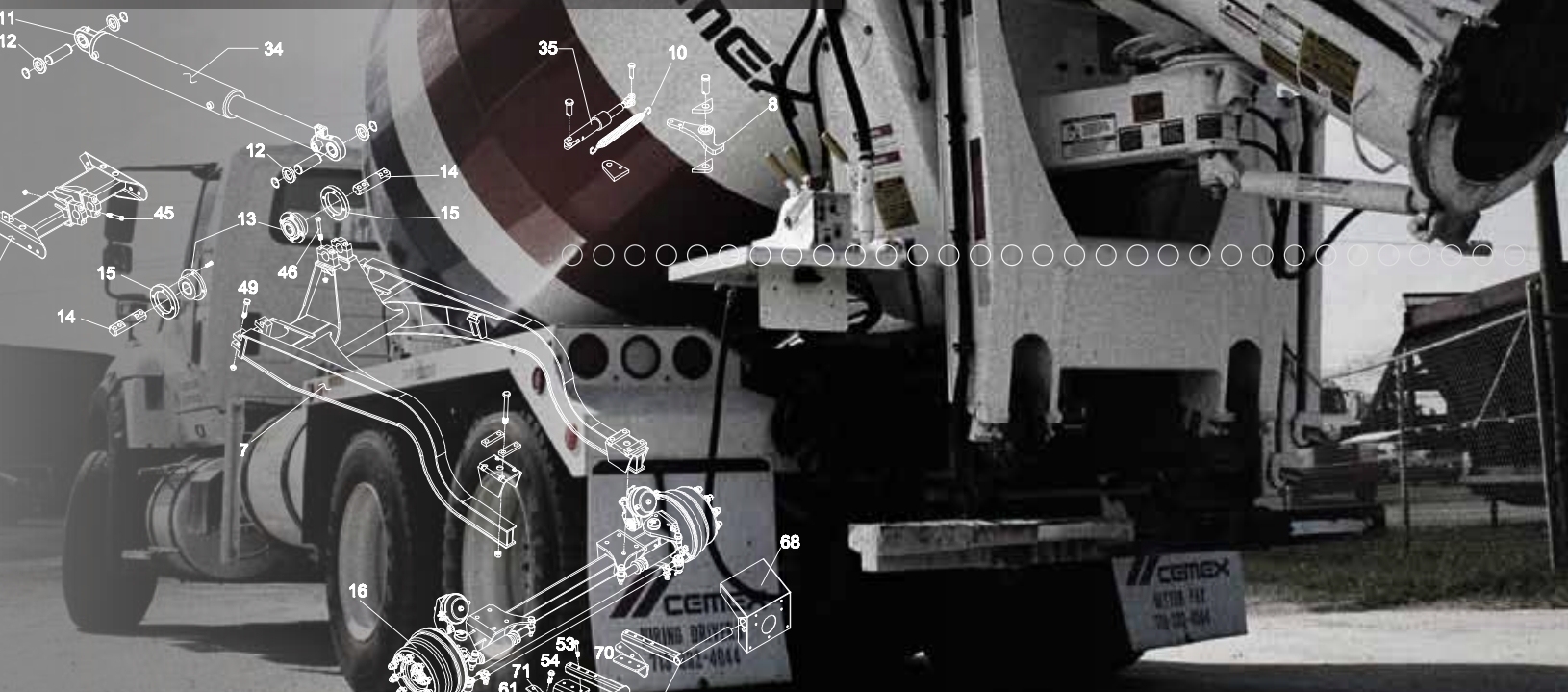

INTERSTATE CLASS



Beck Industrial Key Features

9-12 yd.³ TMMB Rated capacities available

Hendrickson Trailer Axle

Beck T1 Steel single piece trailer arms

Bolt On Double Tapered Spherical Flange Bearing trailer mount

- Superior horizontal axle deflection than traditional bushing mounted trailer axles
- Better road contact, cornering, and consistent axle pressure
- Improved brake and tire life and with reduced flat spots

Bridge Cylinder equipped with external Nitrogen Gauge

Cartridge style block valve for easy manual overrides on all hydraulic functions

Available trailer brake automated engagement with truck service and parking brake

All of the features, options, safety, and benefits of conventional Beck Industrial mixers

